

NOTE: 1. MAXIMUM SPACING OF 3/4" EXPANSION JOINTS TO BE 100' C/C WITH 4 CONTRACTION JOINTS 18'-22' SPACING TO MATCH DRIVEWAY RETURNS.

- A-TRANSVERSE EXPANSION JOINT
- B-LONGITUDINAL OR TRANSVERSE CONTRACTION JOINT (DOWELED).
- C-SAWED TRANSVERSE OR LONGITUDINAL JOINT.
- D-TRANSVERSE TONGUE & GROOVE CONSTRUCTION JOINT

| CROWN SCHEDULE |        |
|----------------|--------|
| 26'            | 36'    |
| 2 1/2"         | 3 1/2" |
|                | 40'    |
|                | 4"     |

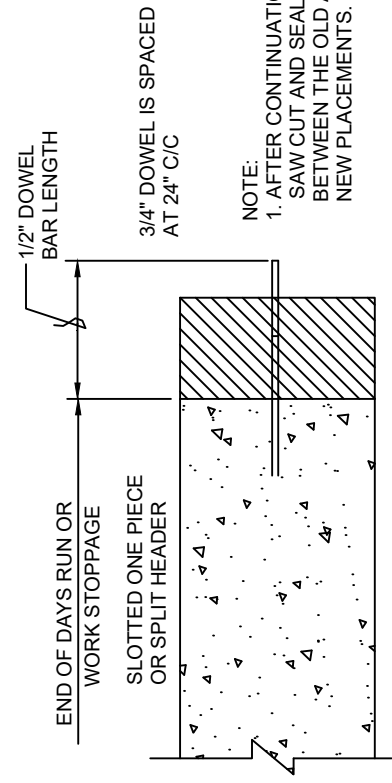

NOTE:  
1. AFTER CONTINUATION PLACEMENT, SAW CUT AND SEAL THE JOINT BETWEEN THE OLD AND THE NEW PLACEMENTS.

TRANSVERSE CONSTRUCTION JOINT

(TO BE USED AT THE END OF DAYS CONCRETING OR ANY STOPPAGE OF 30 MIN. OR MORE.)

| REVISION | BY | DATE |
|----------|----|------|
|          |    |      |
|          |    |      |
|          |    |      |
|          |    |      |
|          |    |      |

**CONCRETE PAVING JOINT PLAN  
(INTERSECTIONS & LANES)**  
STANDARD DETAILS

CITY OF JENKS, OKLAHOMA

ENGINEERING DEPARTMENT

DATE: 4-11-22      STANDARD NO.      STRT-18