

**LEGAL DESCRIPTION**  
(Tract A)

A TRACT OF LAND THAT IS PART OF THE EAST HALF (E/2) OF SECTION SIX (6), TOWNSHIP SEVENTEEN (17) NORTH, RANGE THIRTEEN (13) EAST OF THE INDIAN BASE AND MERIDIAN, TULSA COUNTY, STATE OF OKLAHOMA, ACCORDING TO THE UNITED STATES GOVERNMENT SURVEY THEREOF, BEING MORE PARTICULARLY DESCRIBED AS FOLLOWS:

COMMENCING AT THE NORTHEAST CORNER OF SAID SECTION 6; THENCE SOUTH 88°40'58" WEST ALONG THE NORTH LINE OF SAID SECTION 6 FOR 1431.12 FEET; THENCE SOUTH 00°58'33" EAST FOR 65.00 FEET TO THE **POINT OF BEGINNING** OF SAID TRACT OF LAND, SAID POINT BEING ON THE SOUTH RIGHT OF WAY LINE OF EAST 121<sup>ST</sup> STREET SOUTH; THENCE CONTINUING SOUTH 00°58'33" EAST FOR 1798.57 FEET; THENCE SOUTH 89°01'27" WEST FOR 669.48 FEET TO A POINT ON THE EAST LINE OF BLOCK 2, WAKEFIELD PARK, AN ADDITION TO THE CITY OF JENKS, TULSA COUNTY, OKLAHOMA, RECORDED IN THE OFFICE OF THE TULSA COUNTY CLERK; THENCE NORTH 00°58'33" WEST ALONG SAID EAST LINE AND A NORTHERLY EXTENSION THEREOF FOR 1804.58 FEET TO A POINT ON THE SOUTH RIGHT OF WAY LINE OF EAST 121<sup>ST</sup> STREET SOUTH, SAID POINT BEING 55.00 FEET SOUTHERLY OF THE NORTH LINE OF SAID SECTION 6; THENCE NORTH 88°40'58" EAST PARALLEL WITH AND 55.00 FEET SOUTHERLY OF THE NORTH LINE OF SAID SECTION 6, ALONG SAID SOUTH RIGHT OF WAY LINE FOR 119.83 FEET; THENCE SOUTH 01°19'02" EAST CONTINUING ALONG SAID SOUTH RIGHT OF WAY LINE FOR 10.00 FEET TO A POINT THAT IS 65.00 FEET SOUTHERLY OF THE NORTH LINE OF SAID SECTION 6; THENCE NORTH 88°40'58" EAST PARALLEL WITH AND 65.00 FEET SOUTHERLY OF THE NORTH LINE OF SAID SECTION 6, CONTINUING ALONG SAID SOUTH RIGHT OF WAY LINE FOR 549.60 FEET TO THE POINT OF BEGINNING OF SAID TRACT OF LAND.

SAID TRACT OF LAND CONTAINS 27.639 ACRES OR 1,203,965 SQUARE FEET, MORE OR LESS.

**LEGAL DESCRIPTION CERTIFICATION**

I, SHAWN A. COLLINS, OF SISEMORE & ASSOCIATES, CERTIFY THAT THE ATTACHED LEGAL DESCRIPTION CLOSES IN ACCORD WITH EXISTING RECORDS, IS A TRUE REPRESENTATION OF THE LEGAL DESCRIPTION AS DESCRIBED, AND MEETS THE MINIMUM TECHNICAL STANDARDS FOR LEGAL DESCRIPTIONS OF THE STATE OF OKLAHOMA.

SISEMORE & ASSOCIATES,  
BY SHAWN A. COLLINS

4.29.2021  
DATE

  
SHAWN A. COLLINS  
PLS No. 1788, STATE OF OKLAHOMA  
C. A. NO. 2421 EXPIRES: 6/30/21

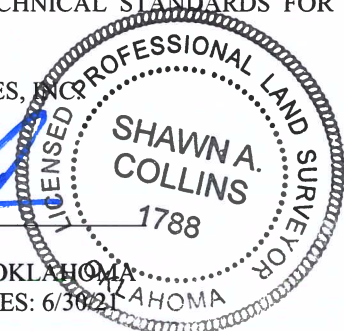

## Parcel Map Check Report

### **Parcel Name: Tract A**

Segment# 1: Line

Course: S0° 58' 33"E

Length: 1,798.57'

Segment# 2: Line

Course: S89° 01' 27"W

Length: 669.48'

Segment# 3: Line

Course: N0° 58' 33"W

Length: 1,804.58'

Segment# 4: Line

Course: N88° 40' 58"E

Length: 119.83'

Segment# 5: Line

Course: S1° 19' 02"E

Length: 10.00'

Segment# 6: Line

Course: N88° 40' 58"E

Length: 549.60'

Perimeter: 4,952.06'

Area: 1,203,964.78 Sq. Ft.

Error Closure: 0.0003

Course: S68° 37' 05"W

Error North: -0.00012

East: -0.00031

Precision 1: 16,506,853.333